



Product advantages

High friction coefficient of approx. 0.3 – 0.4

thanks to the use of glass-fiber-reinforced plastic

Gentle clamping

of the most delicate surfaces, no clamping marks, excellent for ground or surface-treated parts

Low-cost system

through replaceable clamping inserts

High stability

through the aluminum support structure of the supporting jaw

Light, stable design

for high speeds

All-round workpiece locating surface

for low-deformation clamping of machined parts

Technical data

| Description | | Quentes 5 | Quentes 10 |
|-------------|------|-----------|------------|
| | ID | 0300760 | 0300761 |
| Weight | [kg] | 0.13 | 0.28 |

Main views

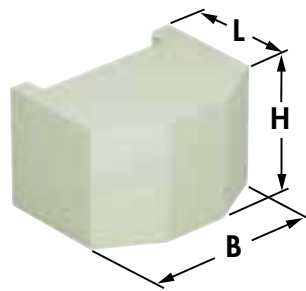

| | | Quentes 5 | Quentes 10 |
|---|------|-----------|------------|
| B | [mm] | 37 | 50 |
| H | [mm] | 25 | 32 |
| L | [mm] | 38 | 38 |



Product advantages

Increased friction factor
so that a lower gripping force is required

Different sizes available

Rapid replacement possible

High load bearing capacity



Technical data

| Description | | HM 6 | HM 8 | HM 10 | HM 11 | HM 12 | HM 13 | HM 14 | HM 15 |
|--------------------|-----|---------|---------|---------|---------|---------|---------|---------|---------|
| ID | | 0300780 | 0300781 | 0300782 | 0300783 | 0300784 | 0300785 | 0300786 | 0300787 |
| Max. load strength | [N] | 4500 | 6000 | 8000 | 11000 | 11000 | 20000 | 30000 | 20000 |
| Keyed surface | | No | No | Yes | Yes | No | Yes | Yes | Yes |

HM 6 – HM 14 clamping insert

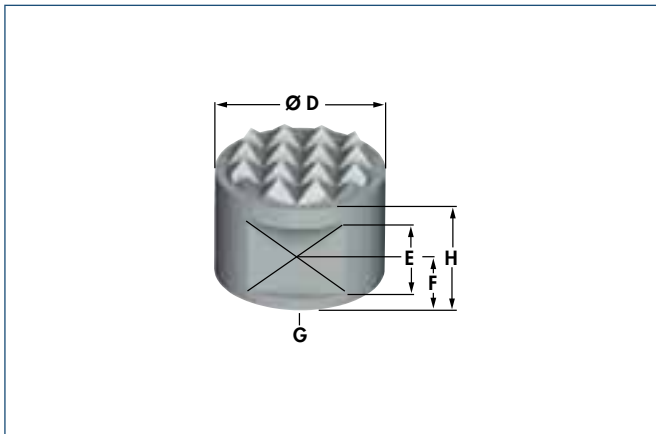

| | HM 6 | HM 8 | HM 10 | HM 11 | HM 12 | HM 13 | HM 14 |
|--------------------|------|------|-------|--------|--------|--------|-------|
| H _{-0.13} | 10 | 10 | 10 | 9.5 | 12.7 | 9.5 | 9.5 |
| D _{-0.13} | Ø 6 | Ø 8 | Ø 10 | Ø 12.7 | Ø 12.7 | Ø 15.8 | Ø 19 |
| F | – | 4.5 | 4.5 | 4.5 | 4.5 | 4.5 | 4.5 |
| E | – | 5 | 5 | 5 | 5 | 5 | 5 |
| Thread G | M3 | M4 | M5 | M5 | M6 | M6 | M6 |

HM 15 clamping insert

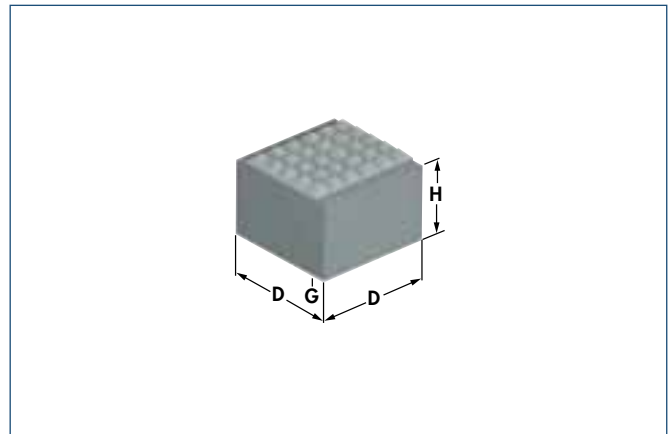

| | HM 15 |
|--------------------|--|
| H _{-0.13} | 9.5 |
| D _{-0.13} | Ø 12.7 ^{+0.08} _{-0.13} |
| F | – |
| E | – |
| Thread G | M6 |



Product advantages

- Pliable surface
- Resistant to harsh ambient conditions
- Easy installation and replacement
- Can be adapted to customer-specific applications
- Ribbed surface for picking up workpieces with delicate surfaces

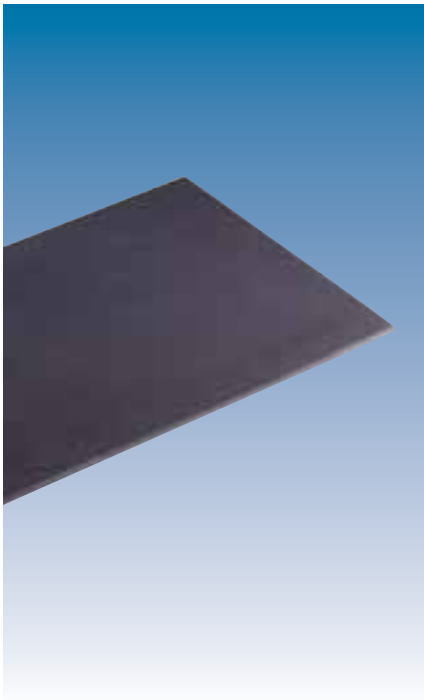

Technical data

| Description | | HKI 1E | HKI 1A | HKI 1S |
|--|----------------------|--------------------|--------------------------|---------------------------------|
| | ID | 0324160 | 0324161 | 0324162 |
| | | elastomer pad only | with aluminum base plate | with stainless steel base plate |
| Weight | [g/cm ³] | 0.3 | 1.0 | 3.6 |
| Operating temperature range | [°C] | -30 to +100 | -30 to +100 | -30 to +100 |
| Coefficient of friction against steel, dry | | ~ 0.5 | ~ 0.5 | ~ 0.5 |
| Elastomer, NBR (Perbunan) | | 60 ± 5 Shore A | 60 ± 5 Shore A | 60 ± 5 Shore A |

Main views

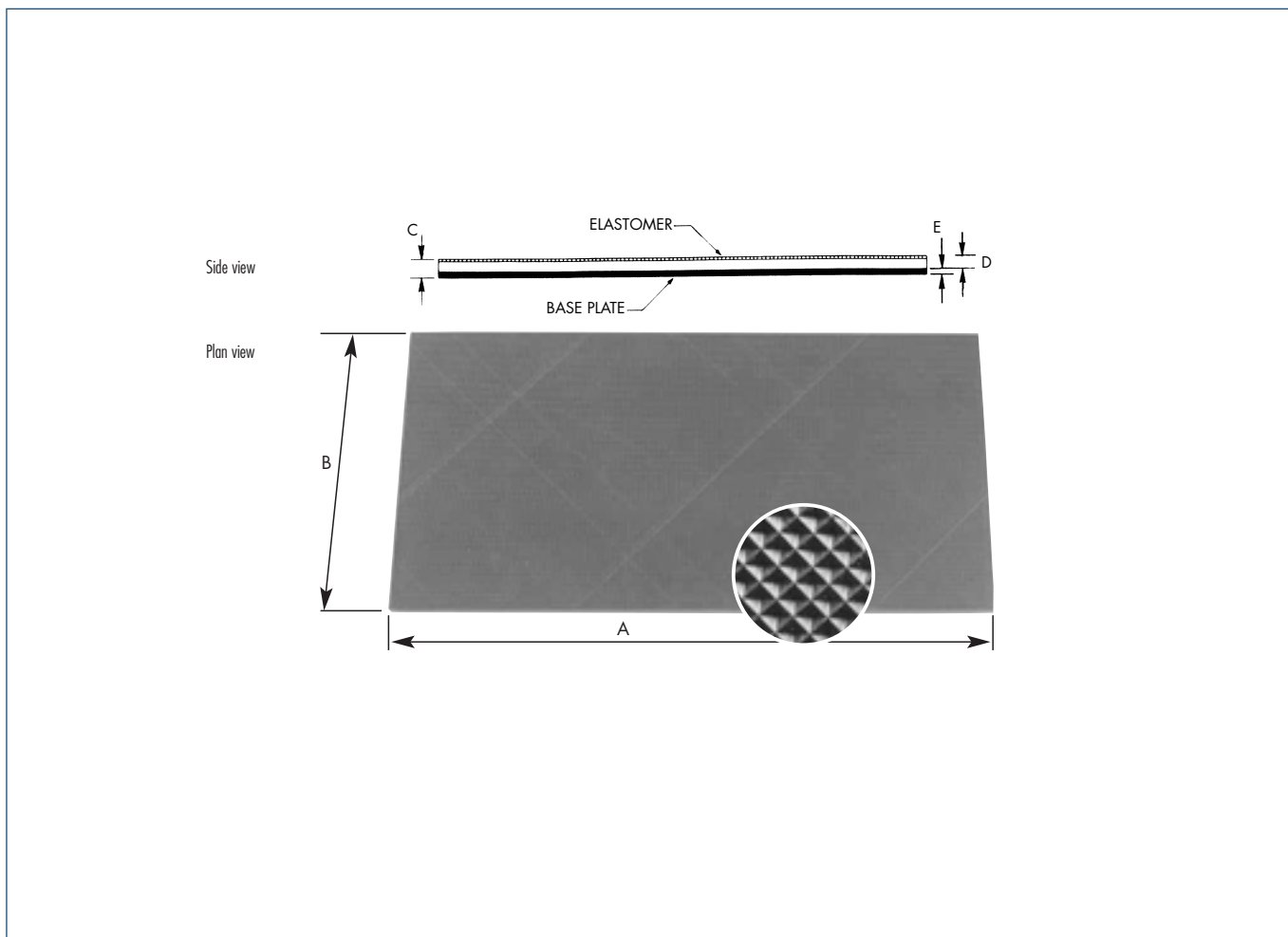

Gripper pads, type HKI 1

Gripper pads of durable, non-slip elastomer material for gripper jaws. Indispensable for applications that work best with a higher friction factor.

The gripper pads can be employed in a wide temperature range and are resistant to oil and other aggressive elements.

Gripper pads are available either with or without metal base plates.

| | | HKI 1 E | HKI 1A | HKI 1S |
|---|------|---------|--------|--------|
| A | [mm] | 300 | 300 | 300 |
| B | [mm] | 150 | 150 | 150 |
| C | [mm] | – | 6.3 | 13.5 |
| D | [mm] | 3.3 | 4.8 | 10.2 |
| E | [mm] | – | 1.5 | 3.3 |

HKI application example

